

*New*

## HEAT-WAVE™ CLASSIC STRIP HEATERS, DUAL MODELS

- **Low Wattage** □ **Medium Wattage** □ **High Wattage**
- **Without Lights** □ **With Lights**

### Features/Benefits:

- ★ Star single model strip heaters safely keep foods at optimum serving temperatures.
- ★ Distributed wattage heating elements reduces “cold zones” towards ends of heat strips. 20% more heat toward the ends.
- ★ Available in widths 18” to 72”.
- ★ Sturdy extruded aluminum housing eliminates sagging.
- ★ Efficiently directed heat.
- ★ Insulated housing minimizes heat loss.
- ★ Element guards provide operator safety.
- ★ Easy to install and models come standard with sturdy adjustable angle brackets.



Model SC36DL1

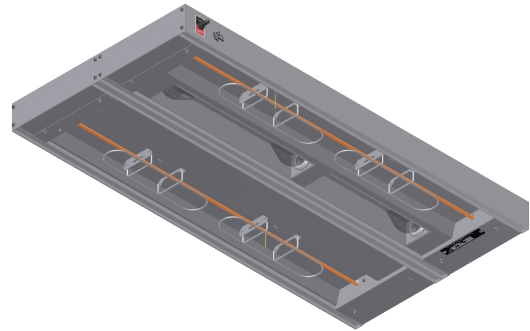

Model SC36DL1

### OPTIONS

#### Power Supply:

##### Standard

- 120V
- 3' Conduit with power supply leads

##### Optional

- 208V Models
- 240V Models

#### Controls:

##### Standard

- On/Off toggle switch

##### Optional

- Infinite Control
- Attached control enclosure
- Remote control enclosure

#### Width:

##### Standard

- 15”

##### Optional

- 18”

### ACCESSORIES

#### Sneeze guards:

- 9-3/8” sneeze guard, one side
- 9-3/8” sneeze guard, two sides
- 14” sneeze guard, one side
- 14” sneeze guard, two sides

### Quality Construction:

Aluminum outer housing and stainless steel interior construction resists corrosion and is easy to clean. Metal-sheathed heating elements.

### Warranty:

Star Strip Heaters are covered by Star’s one year parts and labor warranty.

### MOUNTING OPTIONS

#### Standard

- Adjustable angle brackets

#### Optional

- 10” high non-adjustable tubular stand mounts
- 12” high non-adjustable tubular stand mounts
- 14” high non-adjustable tubular stand mounts
- 16” high non-adjustable tubular stand mounts
- 10” – 14” adjustable tubular stand mounts





*New*

### HEAT-WAVE™ CLASSIC STRIP HEATERS, DUAL MODELS

- Low Wattage □ Medium Wattage □ High Wattage
- Without Lights □ With Lights

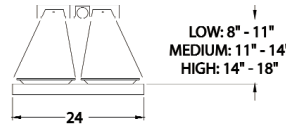
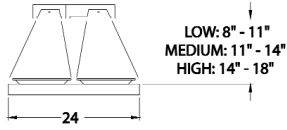

MOUNTING HEIGHT FROM NON-COMBUSTIBLE SURFACE

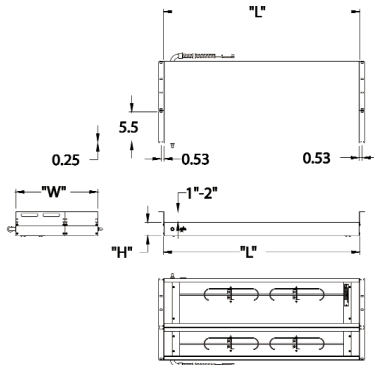

DUAL CLASSIC  
36" MODEL SHOWN

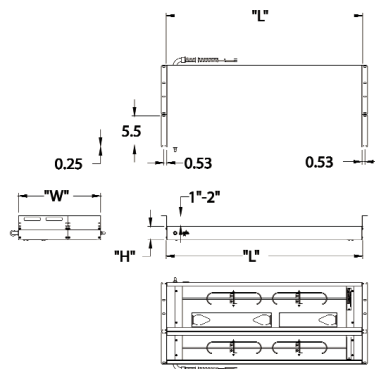

DUAL CLASSIC  
WITH LIGHTS  
36" MODEL SHOWN

#### Overall Dimensions:

Model	Length	Height	Width	Width	Number
Width	"L"	"H"	"W"	"W"	of Lights
18"	18 in. (45.7 cm)	2.5 in. (5.1 cm)	15 in. (38.1 cm)	18 in. (45.7 cm)	2
24"	24 in. (61.0 cm)	2.5 in. (5.1 cm)	15 in. (38.1 cm)	18 in. (45.7 cm)	2
30"	30 in. (76.2 cm)	2.5 in. (5.1 cm)	15 in. (38.1 cm)	18 in. (45.7 cm)	2
36"	36 in. (91.4 cm)	2.5 in. (5.1 cm)	15 in. (38.1 cm)	18 in. (45.7 cm)	3
42"	42 in. (106.7 cm)	2.5 in. (5.1 cm)	15 in. (38.1 cm)	18 in. (45.7 cm)	3
48"	48 in. (121.9 cm)	2.5 in. (5.1 cm)	15 in. (38.1 cm)	18 in. (45.7 cm)	4
60"	60 in. (152.4 cm)	2.5 in. (5.1 cm)	15 in. (38.1 cm)	18 in. (45.7 cm)	5
72"	72 in. (182.9 cm)	2.5 in. (5.1 cm)	15 in. (38.1 cm)	18 in. (45.7 cm)	6

#### MODEL NUMBER CROSS REFERENCE

SC [A] [B] [C] [D] [E] [F]

A- LENGTH

B- 15" Width- (D), 18" Width-(W)

C- POWER: (NONE)-LOW, (M)-MEDIUM, (H)-HIGH

D- LIGHTS (L)

E- TOGGLE: (NONE) OR INFINITE (I), CONTROL BOX: (A) ATTACHED, (R) REMOTE

F- VOLTAGE: (1) 120V - USA & CANADA, (2) 120V - USA ONLY, (3) 208V, (4) 240V

EXAMPLE: SC24DML-1

Size (Length)	Dual	Dual Lighted
	Watts	Watts
18"	550	670
24"	750	870
30"	950	1070
36"	1200	1380
42"	1400	1580
48"	1650	1890
60"	2150	2450
72"	2600	2960

Size (Length)	Dual	Dual Lighted
	Watts	Watts
18"	750	870
24"	1050	1170
30"	1370	1490
36"	1650	1830
42"	1850	2030
48"	2250	2490
60"	2850	3150
72"	3500	3860

Size (Length)	Dual	Dual Lighted
	Watts	Watts
18"	950	1070
24"	1350	1470
30"	1700	1820
36"	2050	2230
42"	2400	2580
48"	2650	2890
60"	3450	3750
72"	4200	4560

#### Notes:

Length does not include mounting brackets or other mounting options.

Lights are 60 watt, 120V

Due to periodic changes in designs, methods, procedures, policies and regulations, the specifications contained in this sheet are subject to change without notice. While Star Manufacturing exercises good faith efforts to provide information that is accurate, we are not responsible for errors or omissions in information provided or conclusions reached as a result of using the specifications. By using the information provided, the user assumes all risks in connection with such use.

Star Manufacturing - 10 Sunnen Drive - P.O. Box 430129 - St. Louis, MO 63143-3800

Phone: (314) 678-6303 - FAX: (314) 781-5445 - www.star-mfg.com