



Project: \_\_\_\_\_  
 Location: \_\_\_\_\_  
 Item #: \_\_\_\_\_  
 Quantity: \_\_\_\_\_

# Undercounter Refrigerator with Stainless Steel Top and Backsplash

## One Section Model with Door

## UR-27-SBS

Case front, doors, top and ends of stainless steel.  
 One piece ABS interior liner with stainless steel coil housing.

## One Section Model with Two Drawers

## URD-27-SBS

Case front, drawers, top and ends of stainless steel.  
 One piece ABS interior liner with stainless steel coil housing.



### Standard Features

- Interior Thermometer
- Easy Closing Door with One Piece Magnetic Gasket
- Door can be Rehinged in the Field
- One Piece Heavy-Duty Door Handle
- Heavy-Duty Vinyl Coated Steel Shelves
- High Density Foamed-in-Place Polyurethane Insulation
- High Impact One Piece ABS Interior Liner
- Plasticized Fin Coil
- Automatic Condensate Evaporator
- Energy Efficient Refrigeration System with Automatic Defrost
- Environmentally Friendly R-134a Refrigerant
- Cord and Plug Attached
- 3" Diameter Heavy-Duty Swivel Casters with Brakes
- Completely Enclosed Cabinet Back

### Optional Features and Accessories

- Door Lock
- Change Door Swing
- Stainless Steel Back
- Adjustable Legs
- 5" Diameter Heavy-Duty Swivel Casters with Brakes
- Adjustable Stainless Steel Legs

### Standard Features

- Interior Thermometer
- Each Drawer has One 12" x 20" x 6" Stainless Steel Pan (Supplied)
- Stainless Steel Drawer Front
- Heavy-Duty Stainless Steel Slides and Ball Bearings
- High Density Foamed-in-Place Polyurethane Insulation
- High Impact One Piece ABS Interior Liner
- Plasticized Fin Coil
- Automatic Condensate Evaporator
- Energy Efficient Refrigeration System with Automatic Defrost
- Environmentally Friendly R-134a Refrigerant
- Cord and Plug Attached
- 3" Diameter Heavy-Duty Swivel Casters with Brakes
- Completely Enclosed Cabinet Back

### Optional Features and Accessories

- Stainless Steel Back
- 5" Diameter Heavy-Duty Swivel Casters with Brakes
- Adjustable Legs
- Adjustable Stainless Steel Legs

|            |  |   |
|------------|--|---|
| Approvals: |  | Victory Refrigeration specification sheets are available online at <a href="http://www.victory-refrig.com">www.victory-refrig.com</a> . |
|------------|--|---|

| CHARACTERISTICS                 | UR-27-SBS | URD-27-SBS |
|---------------------------------|-----------|------------|
| Width, Overall                  | 27        | 27         |
| Depth, Overall (incl. handles)  | 30 1/2    | 30 1/2     |
| Height, Overall (incl. casters) | 38 1/2    | 38 1/2     |
| Depth, Open Door 90°            | 55 3/8    | —          |
| Clear Door Opening, Width       | 23 1/2    | —          |
| Clear Full Door Opening, Height | 25 3/4    | —          |
| Depth, Drawer Open              | —         | 46 1/2     |
| Clear Drawer Width              | —         | 23 1/2     |
| Capacity Net (cubic feet)       | 7.0       | 7.0        |
| No. of Full Doors               | 1         | —          |
| No. of Shelves                  | 2         | —          |
| Shelf Area (square feet)        | 7.2       | —          |
| Each Drawer Pan (cubic feet)    | —         | 1.5        |
| Cabinet Voltage                 | 115/60/1  | 115/60/1   |
| Feed Wires                      | 2         | 2          |
| Condensing Unit Voltage         | 115/60/1  | 115/60/1   |
| Condensing Unit Size (HP)       | 1/5       | 1/5        |
| Total Amperes                   | 5.4       | 5.8        |

| Crated dim. & wts. | Ht.    | Width | Depth | Cu. Ft. | Lbs. |
|--------------------|--------|-------|-------|---------|------|
| UR-27-SBS          | 42 1/2 | 34    | 33    | 27.6    | 157  |
| URD-27-SBS         | 42 1/2 | 34    | 33    | 27.6    | 197  |

Dimensional tolerance ± 1/4" Metric dimensions (MM)

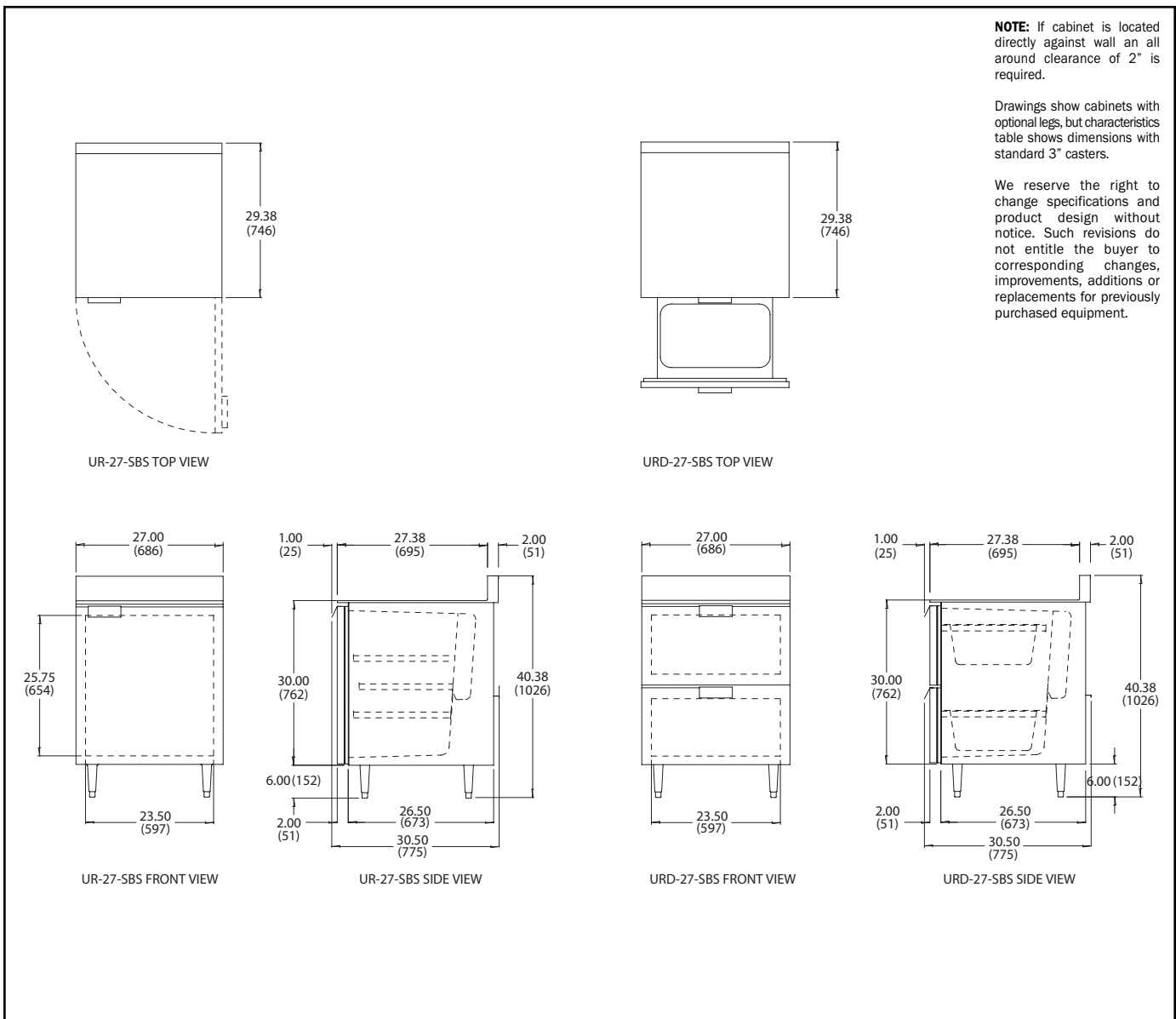

Continuous product development may necessitate specification changes and design without notice.



Victory participates in the KCL CADalog, the most current source of CAD symbols for foodservice designers worldwide. Symbols include standard equipment in plan, side, front and 3-D views, layered for FEDSA/FCSI recommended guidelines.